



# PACKSYS GLOBAL PETinar 2022

UELI KOBEL  
September 2022

“ We create technologies to protect consumers, the environment and your resources in beverage packaging ”



Ueli Kobel

**International Sales Manager & Product Manager  
Beverage & Specialties Division**



## The house of Brückner

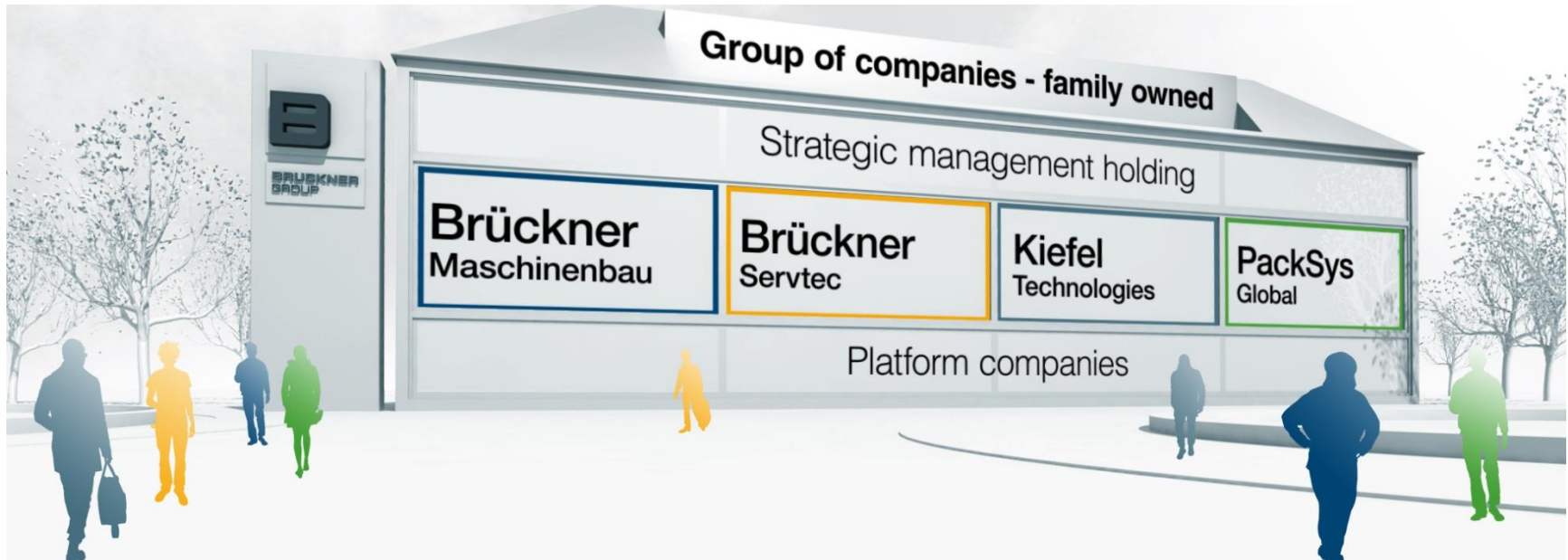

## Key facts



Core  
message

Group of independent and strong  
machine building companies



Employees

More than 2,400 worldwide



Headquarters

Siegsdorf, Bavaria



Foundation

1960



# Our Customer Products

We are around you – 24/7



# Business Divisions

Our team is focussed on your needs.

A global leader for more 50 years in packaging technology. With pride PackSys Global's has etched Swiss values into the companies DNA.

PACKSYS  
GLOBAL



SWISS  
MADE

## SWISS



### Health & Pharma

Health & pharma tubes.  
Tube packing machines.



### Premium Cosmetics

Cosmetic tubes.  
Tube packing machines.  
Cosmetic decoration.



### Beverage & Specialities

Beverage closures.  
Metal & plastic packing machines.  
Decoration on bottles & closures.  
Automotive & plastic decoration.



### Customer Service

Remote service.  
Digital Service.  
Service agreements.  
Discontinued machines.

# We are global

**PACKSYS**  
GLOBAL



We can reach you  
from everywhere

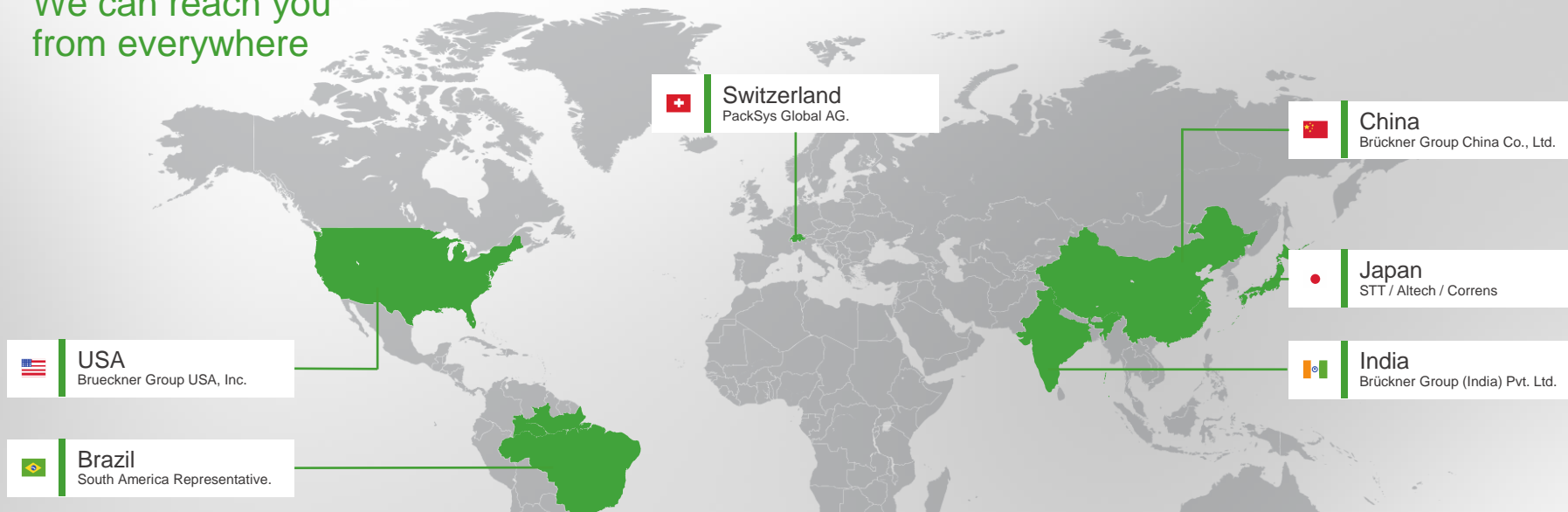

**Product**  
Innovative Packaging



**Customers**  
in 90 countries



**Employees**  
More than  
300 Worldwide



**Headquarters**  
Rueti (Main HQ)  
Haldenstein (CH)  
Burgdorf (CH)



**Established**  
1969

# Caps and Closures

---

## Evolution

- Forming/making a first opening detection on closures is our passion for more than 50 years...!
- More than 500 machines for plastic closures
- Output rate 1995: 1'000ppm 2022: 3'500ppm
- Slitting / folding slitting / slitting folding / tethered slitting
- 18mm to 90mm diameter
- ...always following the market needs and trends



SWISS  
MADE





# Slitting and folding machines

## Few key points

- Our slitting technology results in very accurate and consistent opening torque
- Our machines have been developed with Swiss technology, conducting S and F operations with highest level precision
- We developed solutions to “tether” the cap to the bottle
- We invented the capLAB – the first inline closure quality inspection system.
- All our machines can be adapted for **conventional** or different types of **tethered** cap morphology



SWISS  
MADE



# Slitting and folding machines

## Few key points

- Sustainable solutions and tethered designs = market drivers
- PSS process support from the idea to commercial production
- Innovation push by tethered requirement
  - experTether
  - smarTether
  - CapCompass
- Closure design with hybrid process technologies
- Integrated quality and production recording



Tethered Closures come in various shapes...

## ■ ...but still Performs Multiple Functions

- Sealing: prevent spillage and CO<sub>2</sub> loss
- Prevent the entry: insects, O<sub>2</sub>, airborne pollutants such as dust & allergens
- **Tamper-evidence**

## ■ Consumer experience

- Sensory experience: knurls spacing,
- Radius, depth, resin
- Grip zone
- Anti-tilt
- Convenience

## ■ Manufacturers topics

- Investments
- Filling line – capper setup
- High Performance and efficiency
- Zero defects
- ...



# Caps and Closures

---

## Slit or molded hinge



## Oriented slitting – CapCompass

- Hinge positioned
- Defined flip away direction
- Multi slitting levels
- Vertical slitting

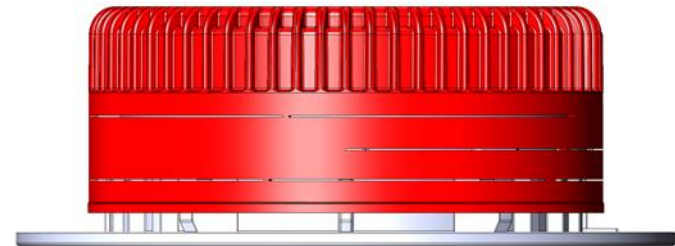
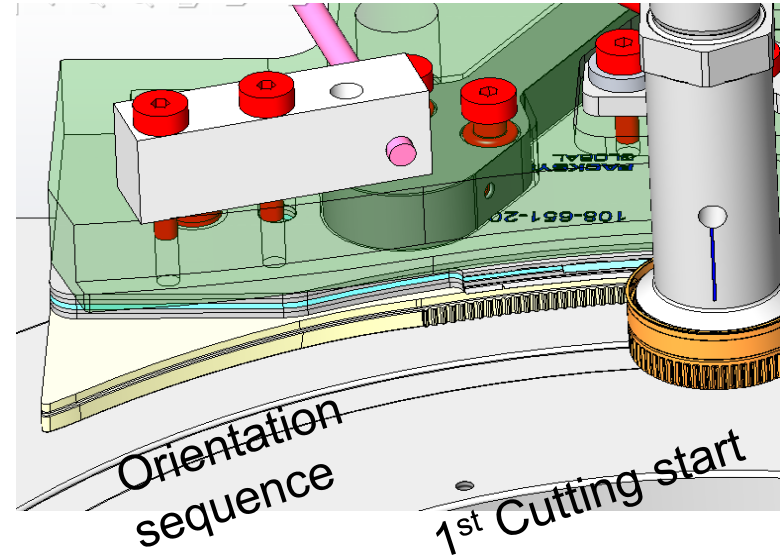

## Contour slitting – **experTether**

- Synchronized mandrels
- Slit contour on mandrel AND knife (Block knife)
- experTether as known from the high speed machines

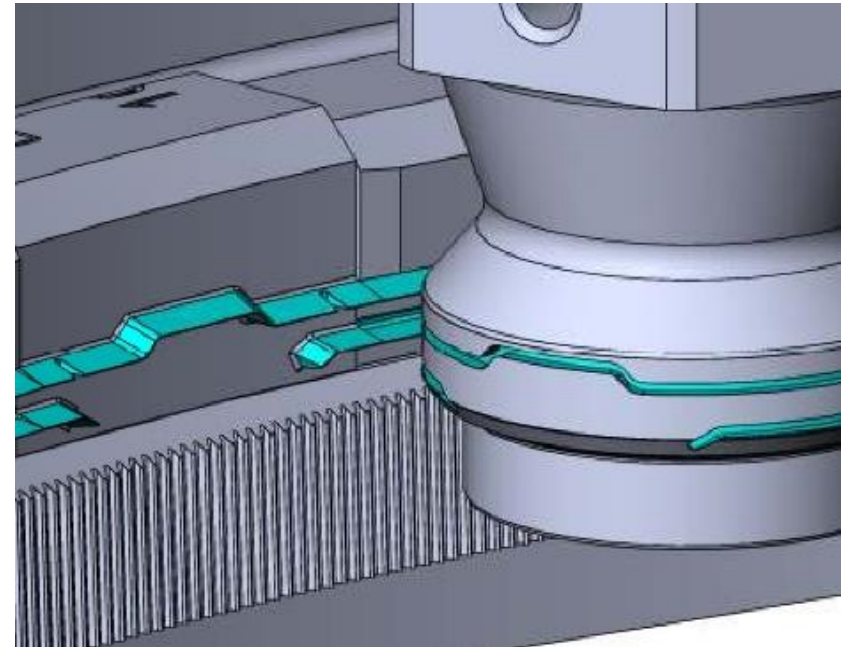

# Caps and Closures

---

## Transition

- Combined closure designs
- Quick changeover from single cut to tethered
- Hybrid manufacturing methods
- Modularity



# TEM PLUS

- Always identical high precision slit geometry
- Flexible process sequence for special closure designs
- Gentle product handling – no vertical movements
- Contour slitting and synchronized slitting for tethered applications

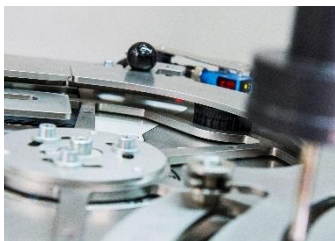

LOADING “PICK AND PLACE” PRINCIPLE



SLITTING PRINCIPLE



TETHERED APPLICATIONS



FOLDING



DISCHARGE TO VACUUM CONVEYOR BELT



 SWISS MADE

The new slitting / folding machine for speciality closures.



## Specifications TEM Plus

- Nominal Diameter range: 18mm-38mm (~45mm outside)
- Closure Height: 10mm - 48mm
- Speed:800ppm for height up to 48mm
- Speed:1'000ppm for height up to 27mm
- Process sequence flexibility as on standard TEM (FS /SF)

# Slitting and folding machines

## capLAB

- capLAB – the first inline TE band testing device
- Closed loop
- Various testing pattern
- Slit or moulded bridges
- Easy data transfer
- Always identical measuring conditions



SWISS  
MADE



# Caps and Closures

capLAB

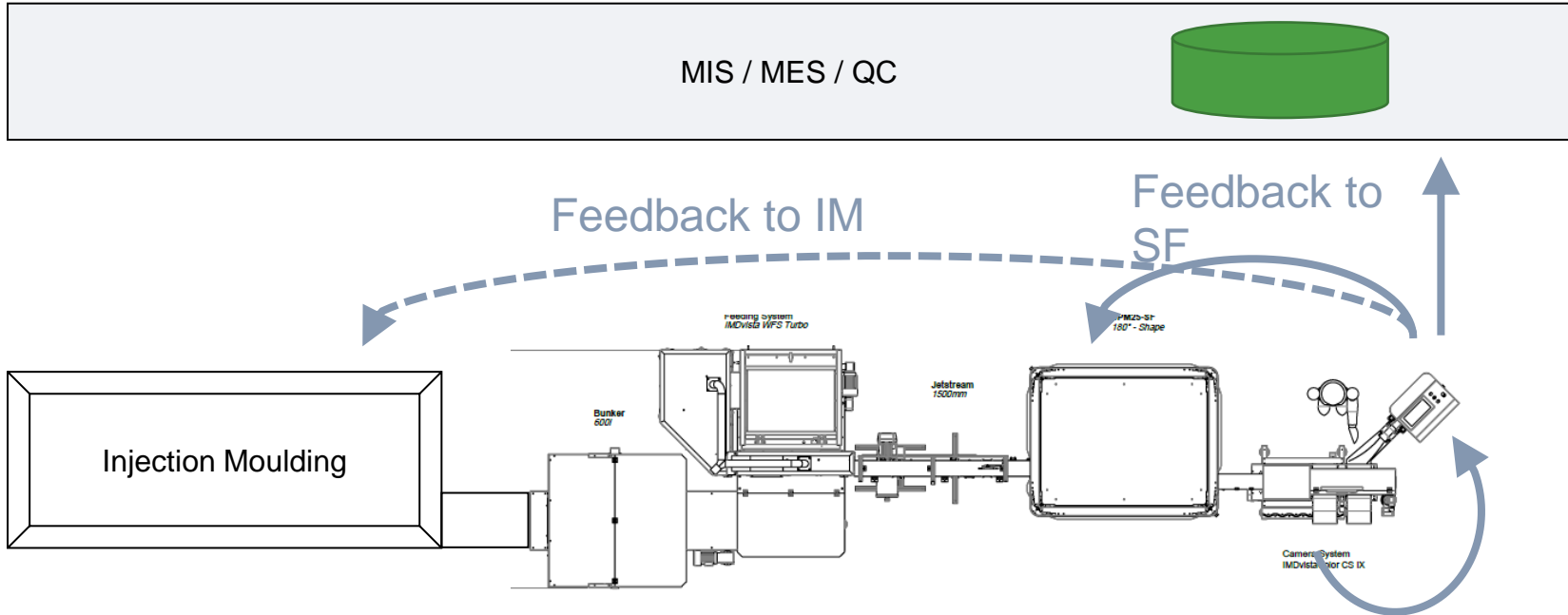

# Caps and Closures

## capLAB+

- capLAB+
- Everything we know from capLAB remain inside
- Extended TE Band testing for **tethered applications**
- An **additional** major closure testing process transferred from the lab to the machine – **come and see it in Munich at Drinktec**

**PACKSYS**  
GLOBAL



SWISS  
MADE

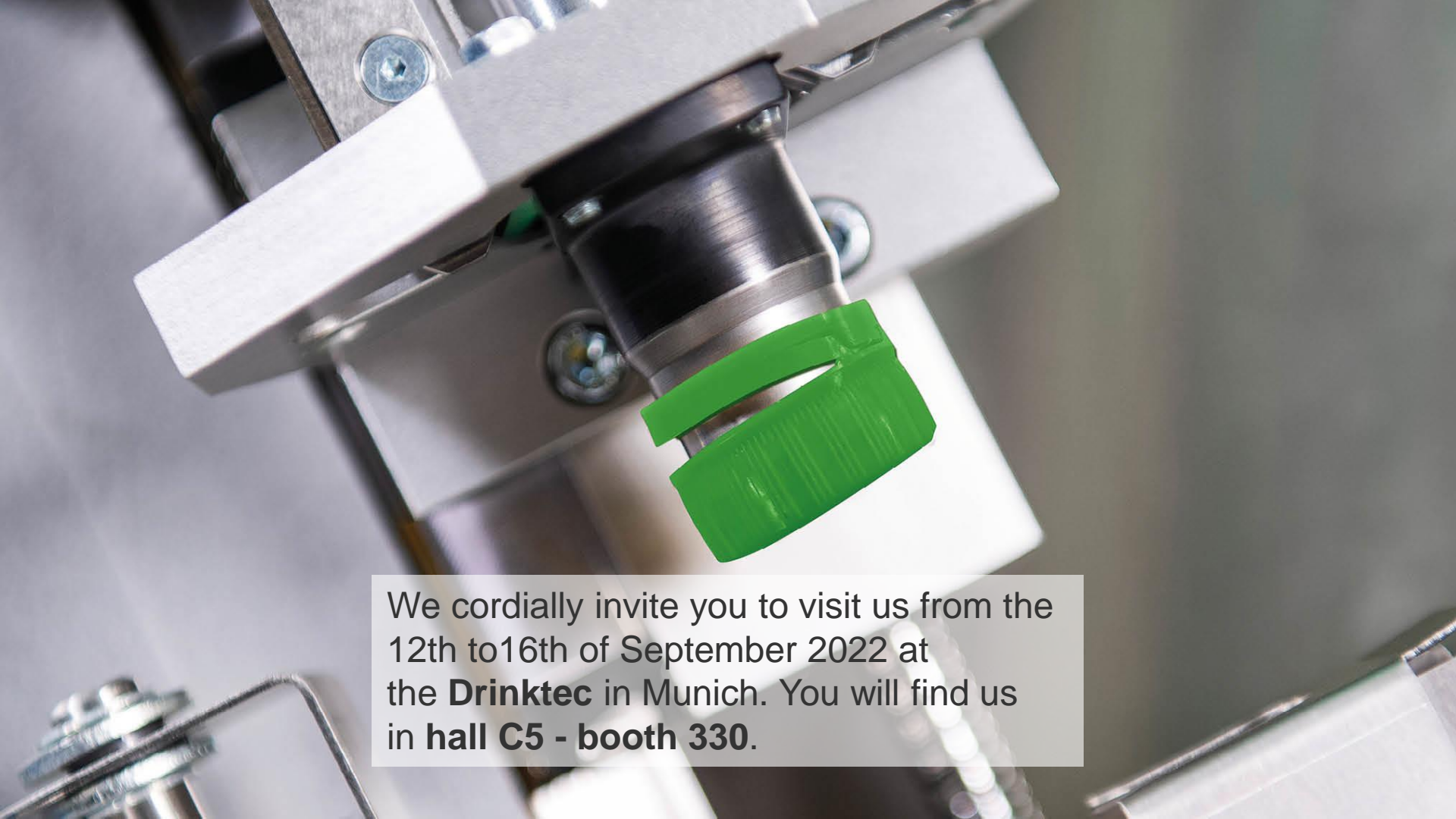

A close-up photograph of a mechanical assembly, likely a part of a machine. The assembly consists of several metallic components, including a silver-colored metal block at the top, a black cylindrical component in the middle, and a bright green, textured cylindrical component at the bottom. The green component has a ribbed surface. The background is a blurred, light-colored surface, possibly a workbench or machine frame. The lighting is bright, highlighting the metallic surfaces and the vibrant green color.

We cordially invite you to visit us from the 12th to 16th of September 2022 at the **Drinktec** in Munich. You will find us in **hall C5 - booth 330**.

Thank you for your attention!

**PackSys Global AG**

Spitalstrasse 38

8630 Rüti, Switzerland

Phone: +41 55 253 37 00

Fax: +41 55 253 37 99

Email: [info@packsysglobal.com](mailto:info@packsysglobal.com)

